

SPORTSMEN[®]

Fifth Wheels

2018 Décor



French Roast



Linen

Standards

- New Aerodynamic Front Profile
- Diamond Plate Rock Guard on Front of Travel Trailers
- Enclosed Pin Box on FW's
- 3/8" Fully Walk-On Roof Decking
- 1-Piece Seamless Roof w/ SuperFlex[®] Roofing Material
- Awning w/Drip Rail & Spouts
- Tinted Windows
- Super-Sized Panoramic Slideroom Window
- Radius Entry Door
- Smooth Screwless Baggage Doors
- LED Pass-Through Storage Light
- Cable Hookup
- Digital TV Antenna w/Booster
- Self-Adjusting Electric Brakes
- Radial Tires
- Rear Bumper w/Sewer Hose Storage
- Winter Bypass Kit
- 2 or 4 Stabilizer Jacks (model specific)
- Outside Shower (N/A w/outside kitchen)
- (2) 30# Gas Bottles w/Bottle Cover
- 30 AMP Service
- 13,500 BTU A/C
- 3-Burner Cooktop
- Range Hood w/12V Light & Exhaust Fan
- Microwave w/Turntable
- Oven
- Acrylic Sink w/High-Rise Faucet
- Roller Ball Bearing Drawer Guides
- Large Overhead Cabinets
- LED Interior Lighting
- Linoleum Throughout
- Monitor Panel

- Built-In Medicine Cabinet w/Mirror in Bath
- Shower Surround
- Power Vent in Bath
- Skylight over Shower
- Queen Mattress
- Reversible Quilted Comforter
- Flush-Floor Bedroom (FW)
- Main Bedroom Roof Vent

Options

- Color-Infused Ivory Exterior Fiberglass (required on FWs)
- 15,000 BTU A/C IPO 13,500 BTU A/C
- 50 AMP Service w/2nd A/C Prep
- 2nd A/C (13,500 BTU)
- 39" LED TV (N/A 231RK)
- 32" LED TV (231RK)
- Bedroom LED TV w/Inside/Outside Bracket
- Radiant Technology PKG (foil in floor, roof, front, rear)
- F/S Dinette Table & (4) Chairs IPO Dinette
- Tri-Fold HAB Sofa IPO Jackknife
- Plumb for W/D w/50 AMP
- Theater Seating IPO Jackknife (262RLK) (required on 344BH)
- Electric Rear Stabilizer Jacks (FWs)
- Fireplace (N/A 231RK)
- Aluminum Wheels (STD on FWs)
- 10 CU FT Residential Refrigerator IPO 8 CU FT Gas/Electric Refrigerator
- Central Vacuum (FWs only)
- MaxxAir[®] Vent Fan in LR or Bath
- Trundle Bed IPO Dinette in Bunk Slide (302BHK)

- Wireless Backup Camera System – Observation
- Bumper-Mount Grill
- Roof Ladder
- Motion Security Sensor for Smart Arm Awning
- Wind Sensor for Smart Arm Awning

K-Z Advantage Package

(mandatory option)

Exterior

- 2-Toned Exterior Metal (TTs)
- Power Awning w/LED Light
- Key-Alike for Baggage & Entry Doors
- Friction Hinge Entry Door
- Large Folding Grab Handle
- Alumitread[®] Entry Steps
- Amber Step Light
- Power Front Jack
- Spare Tire
- EquaFlex[®] Suspension
- Nitrogen-Filled Tires
- Flip-Down 71" Storage Rack
- Exterior Speakers
- Battery Disconnect
- Black Tank Flush
- ToyLock
- Backup Camera Prep
- Solar Prep
- Climate Package (heated, enclosed & insulated underbelly)

Interior

- Seamless Countertops w/Under-Mount Kitchen Sink
- Sink Cover
- Drop-In Cooktop w/Glass Cover
- Kitchen Skylight
- Storage Bins in Booth Dinette

- Blue LED Light Strip above Main Slideroom(s)
- Jackknife w/Middle Console & Bolster Arms
- (2) Motion Sensor Lights
- Multiple Media Stereo w/DVD/Bluetooth/NFC Wireless Connectivity
- (2) 6 1/2" Interior Speakers
- 12V Dual USB Port
- Pleated Shades
- Foot Flush Toilet
- Bed Storage System
- Plywood Bed Base w/Gas Struts
- Upper Bunk Windows (select models)
- Pillowtop Mattress
- Push-Back Recliners (select models)

K-Z Convenience Package

(mandatory option)

Exterior

- Smart Arm Awning w/Exterior Controls
- 16" Tires w/Aluminum Wheels (FWs, N/A 231RK)
- Magnetic Baggage Door Catches
- Omnidirectional HDTV Antenna
- LED Lights in Exterior Speakers

Interior

- Armstrong[®] ToughGuard[®] Linoleum
- 8 CU FT Gas/Electric Refrigerator
- Stainless Steel Residential Kitchen Faucet w/Pulldown Sprayer
- Surfex[®] Wood Step in FW Hallway
- Interior Control Switches on OH End Cabinet
- Dark Accent Trim on Corners/Entry Doors
- Electric Outlet in Bunk Area

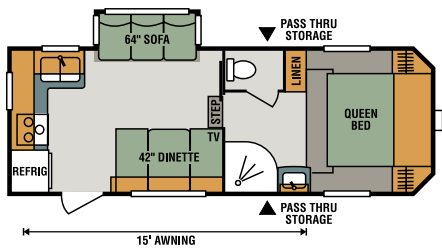

231RK

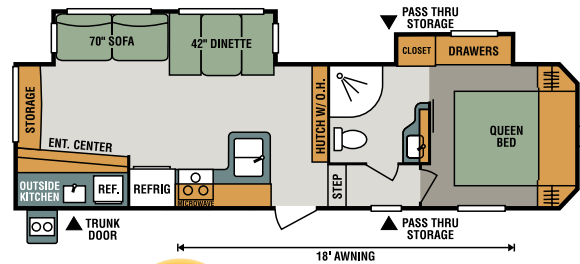

262RLK **NEW**

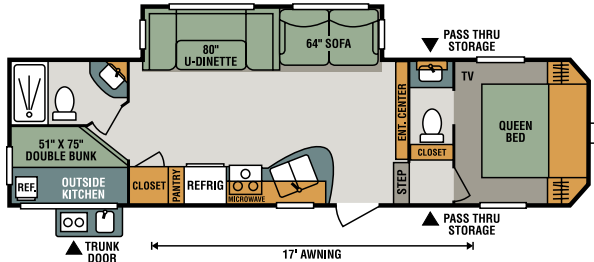

281BHK **NEW**

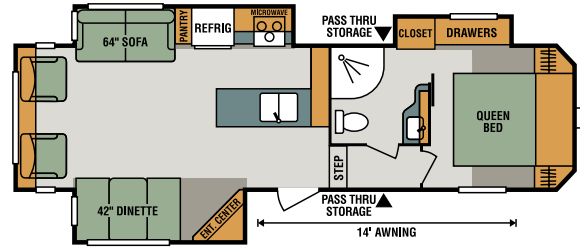

293RL

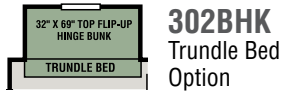

302BHK
Trundle Bed
Option

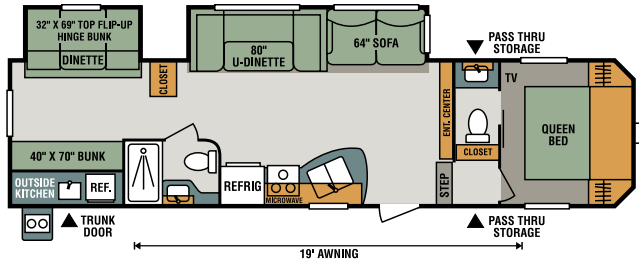

302BHK **NEW**

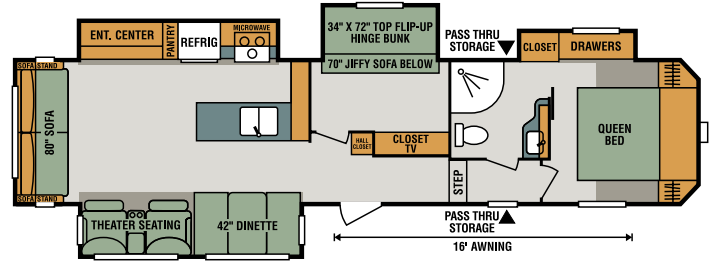

344BH

Fifth Wheels	231RK	262RLK	281BHK	293RL	302BHK	344BH
UVW (Unloaded Vehicle Weight)*	5,925	TBD	TBD	7,860	TBD	10,030
Dry Hitch Weight*	860	TBD	TBD	1,620	TBD	1,800
Dry Axle Weight*	5,065	TBD	TBD	6,240	TBD	8,230
NCC (Net Carrying Capacity)	1,075	TBD	TBD	1,340	TBD	1,970
GVWR	7,000	8,800	8,800	9,200	10,000	11,995
Interior Height	92"	92"	92"	92"	92"	84" - 95"
Exterior Height w/ A/C	11' 8"	12' 5"	12' 5"	12' 5"	12' 5"	12' 7"
Exterior Width	96"	96"	96"	96"	96"	96"
Exterior Length	25' 4"	30' 2"	31' 3"	32' 9"	34' 7"	39' 7"
Refrigerator (cu. feet)	8	8	8	8	8	8
Water Heater Cap. (gal. G/E w/DSI)	6	6	6	6	6	6
Fresh Water Cap. (gal.)	38	38	38	38	38	38
Waste Water Cap. (gal.)	57	57	64	57	64	57
Gray Water Cap. (gal.)	89	89	32	57	32	89
LP Gas Cap. (lbs.)	60	60	60	60	60	60
Furnace BTUs (1,000s)	25	30	30	30	30	30
Tire Size	15"	16"	16"	16"	16"	16"
Awning	15'	18'	17'	14'	19'	16'

*This weight reflects the rolling average unit weight for each model. Your trailer weight will vary according to optional equipment.



985 N 900 W • Shpshewana, IN 46565
E-mail kz@kz-rv.com • www.kz-rv.com

Due to continual research and advances, manufacturer reserves the right to change specifications, design, price and equipment without notice, and assumes no responsibility for any error in this literature. Some items shown are not included as standard or optional equipment. ©2017KZ | 8/30/17 | 15M