

Sportsmen classic by KZ

Ultra Lightweight Travel Trailers



Standards

- 1 LP Tank
- 2 Burner Gas Hot Plate
- 2 Stabilizer Jacks
- 6 Gallon Gas DSI Water Heater
- 12 Volt Converter with Charger
- 13"/14" Tires
- 5" Thick Dinette Seats
- Alum-A-Tough Roofing with 12 Year Limited Warranty
- Awning with Hardware
- Cable Hook Up
- City Water Fill
- Diamond Plate on Front
- Full Aqualon Tents with 5 Year Warranty
- Gas/Electric Refrigerator

- LED Interior Lights
- Microwave
- Norco/Bal Frame (E-Coated) and A-Frame (Epoxy Painted)
- Overhead Cabinets
- R-7 Insulation
- Radial Tires
- Rear Bumper with Sewer Hose Storage
- Self-Adjust Electric Brakes
- Shower and Toilet
- Single Bowl Sink
- Spare Tire
- Tank Monitor Panel
- Tinted Windows
- TV Antenna

Options

- 2 Additional Stabilizer Jacks
- 6 Cubic Foot Refrigerator (Floorplan Specific)
- 8,000 BTU Air Conditioner
- 13,500 BTU Air Conditioner (Roof Air)
- 16,000 BTU Furnace
- AM/FM/MP3/iPod Radio
- Front Window (N/A on Tent Models and 17FKTH)
- Power Lighted Awning
- Surge Brakes
- U-Dinette IPO Front Bed

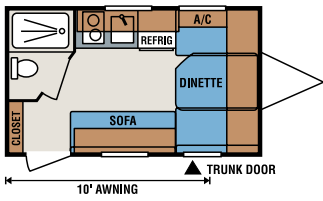

14RB

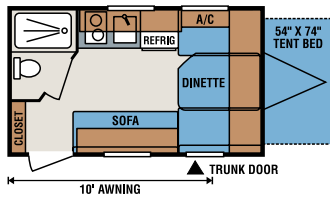

14RBT

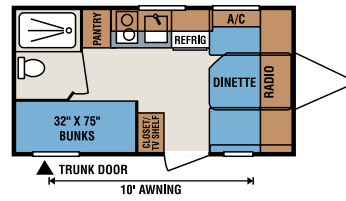

16BH

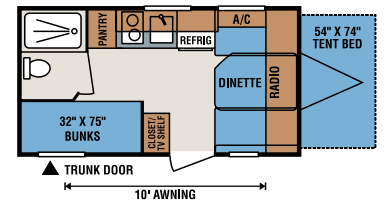

16BHT

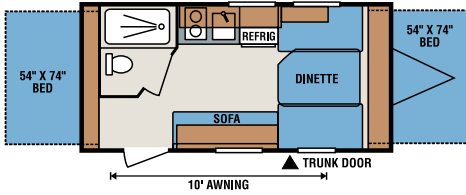

16RBT

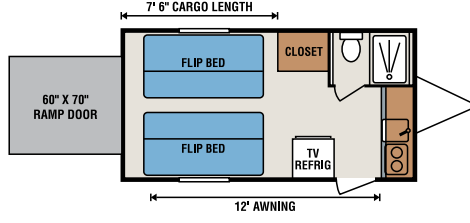

17FKTH

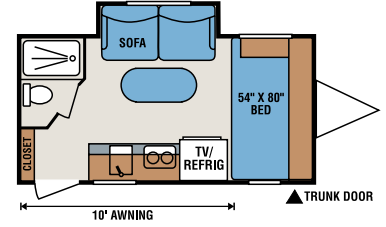

17RBS

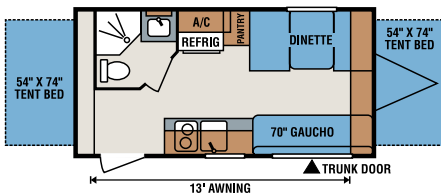

18RBT

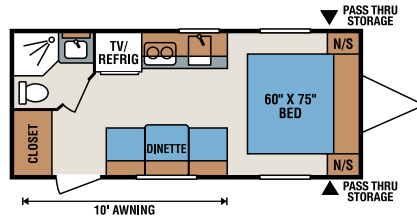

190

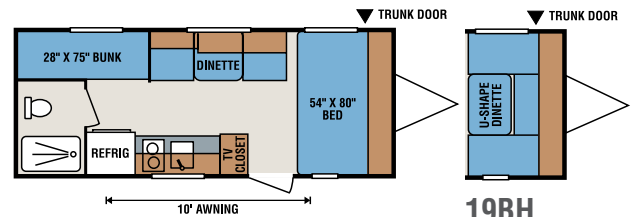

19BH

19BH
U-Shape
Dinette Option

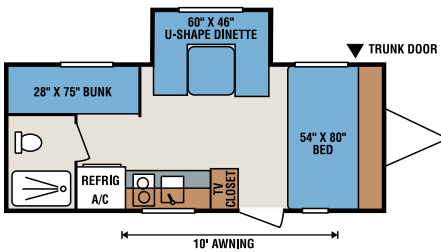

19BHS

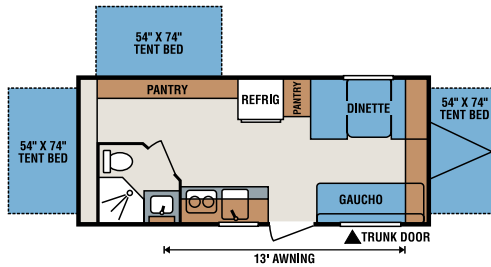

20RBT

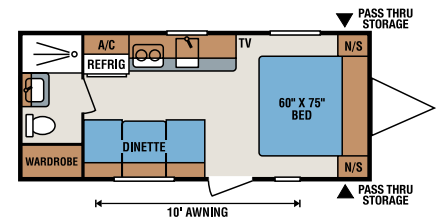

200

Travel Trailers	14RB	14RBT	16BH	16BHT	16RBT	17FKTH	17RBS	18RBT	190	19BH	19BHS	20RBT	200
UVW (Unloaded Vehicle Weight)*	2,126	2,170	2,263	2,350	2,383	2,400	2,530	2,696	2,740	2,623	2,840	3,116	2,713
Dry Hitch Weight*	323	400	343	380	343	350	420	336	376	346	370	426	336
Dry Axle Weight*	1,803	1,770	1,920	1,970	2,040	2,050	2,110	2,360	2,364	2,277	2,470	2,690	2,377
NCC (Net Carrying Capacity)	674	630	537	450	417	1,100	970	804	760	877	660	1,384	787
GVWR	2,800	2,800	2,800	2,800	2,800	3,500	3,500	3,500	3,500	3,500	3,500	4,500	3,500
Interior Height	75"	75"	75"	75"	75"	75"	75"	75"	75"	75"	75"	75"	75"
Exterior Height w/o A/C	101.5"	101.5"	101.5"	101.5"	98"	102"	107"	111"	103"	100"	107"	115"	103"
Exterior Width	84"	84"	84"	84"	84"	90"	84"	90"	90"	84"	84"	90"	90"
Exterior Length	15' 10"	15' 10"	17' 2"	17' 2"	17' 2"	17' 4"	17' 11"	18' 10"	22' 1"	20' 6"	20' 6"	21'	22'
Refrigerator (cu. feet)	3	3	3	3	3	3	4.6	4.6	4.6	4.6	4.6	5	4.6
Water Heater Cap. (gal. G/E w/DSI) <i>OPTIONAL</i>	6	6	6	6	6	6	6	6	6	6	6	6	6
Fresh Water Cap. (gal.)	20	20	20	20	20	38	20	20	20	20	20	20	20
Waste Water Cap. (gal.)	9	9	9	9	9	5	9	24	32	9	9	24	26
Gray Water Cap. (gal.)	15	15	15	15	15	26	15	32	32	15	15	32	32
LP Gas Cap. (lbs.) <i>OPTIONAL</i>	20	20	20	20	20	20	20	20	20	20	20	20	20
Furnace BTUs (1,000s) <i>OPTIONAL</i>	16	16	16	16	16	16	16	16	16	16	16	16	16
Tire Size	13"	13"	13"	14"	13"	14"	14"	14"	14"	14"	14"	13"	14"
Awning <i>OPTIONAL</i>	10'	10'	10'	10'	10'	12'	10'	13'	10'	10'	10'	13'	10'

*This weight reflects the rolling average unit weight for each model. Your trailer weight will vary according to optional equipment.



985 N 900 W • Shippshewana, IN 46565
E-mail kz@kz-rv.com • www.kz-rv.com

Due to continual research and advances, manufacturer reserves the right to change specifications, design, price and equipment without notice, and assumes no responsibility for any error in this literature. Some items shown are not included as standard or optional equipment. ©2015KZ | 8/28/15 | 10M